

HAMPTON CREEK / HERBERTS CREEK PROJECT CONDITION SURVEY OF JUNE AND JULY 2011 HAMPTON, VIRGINIA

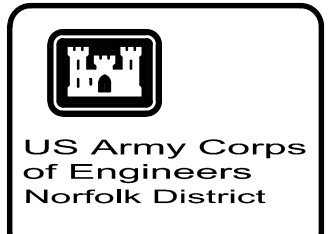

REV.	DATE	DESCRIPTION	BY	APP.

DESIGNED BY: R.J.W.	DATE: 11 OCT 2011
DRAWN BY: M.L.M.	AS SHOWN
CHECKED BY: K.H.	
PROJECT NO.: HTC.2011-06-29.CS(1)	
DRAWING NO.:	
SURVEYED BY: A.M.P.	

HAMPTON CREEK/HERBERT CREEK
 PROJECT CONDITION
 SURVEY OF JUNE AND JULY 2011
 HAMPTON, VIRGINIA

- NOTES -

PROJECT DIMENSIONS: Hampton Creek channel is 12 feet deep, 200 feet wide across Hampton Flats and 150 feet wide inside the creek to Settlers Landing Road Bridge. Herberts Creek channel is 12 feet deep, 100 feet wide from the Hampton Creek channel for approximately 1,300 feet, thence 80 feet wide to Kecoughtan Road (formerly Jackson Street).

MEAN LOWER LOW WATER (MLLW), National Tidal Datum Epoch (NTDE) 1983-2001, was determined by the National Ocean Service (NOS) and is 1.68 feet below the North American Vertical Datum (NAVD) of 1988.

SOUNDINGS are in feet referred to NOS MLLW, and were taken on 29 June and 5 and 6 July 2011. The darkened sounding(s) depicts the controlling depth(s) for the channel/reach.

MEAN RANGE OF TIDE is 2.60 feet at Phoebus, Hampton, Virginia based on NOS observations, NTDE 1983-2001.

COORDINATES are referred to the Virginia State Plane Coordinate System, South Zone, in U.S. survey feet, and are based on the North American Datum of 1983.

PLANIMETRIC FEATURES were developed by stereo-photogrammetric methods from aerial photos flown 9 June 2004 by EarthData International of Maryland and by USACE topographic surveys.

LAST DREDGED by McLean Construction Company during the period 19 January 2010 through 1 April 2010 under Contract No. W91236-09-C-0074 dated 26 August 2009.

The information depicted on this map represents the results of surveys made on the date(s) indicated and can only be considered as indicating the general conditions existing at that time.

SIGNATURES AFFIXED BELOW INDICATE OFFICIAL RECOMMENDATION AND APPROVAL OF ALL DRAWINGS IN THIS SET AS INDICATED ON INDEX TO DRAWINGS.

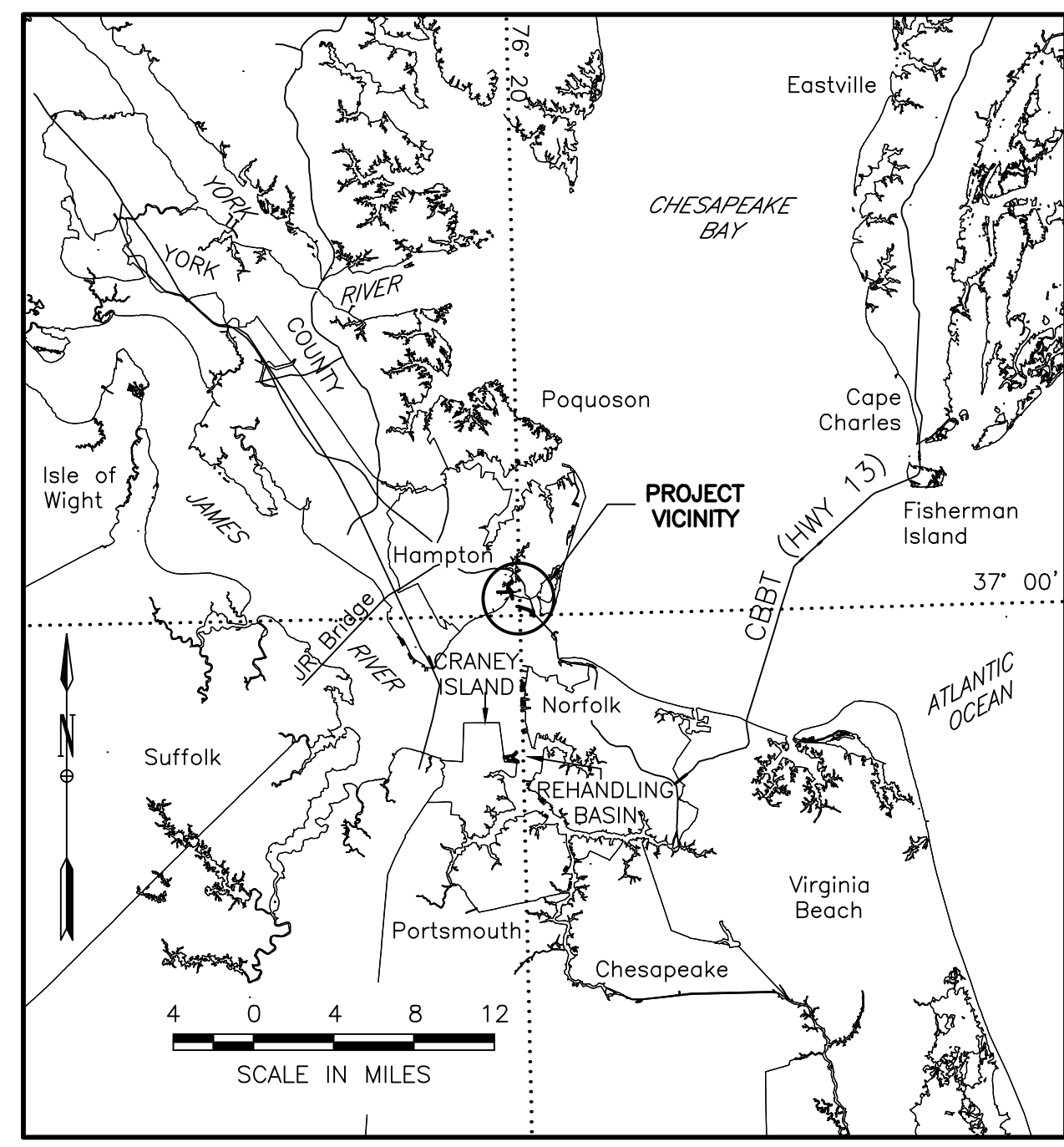

VICINITY MAP

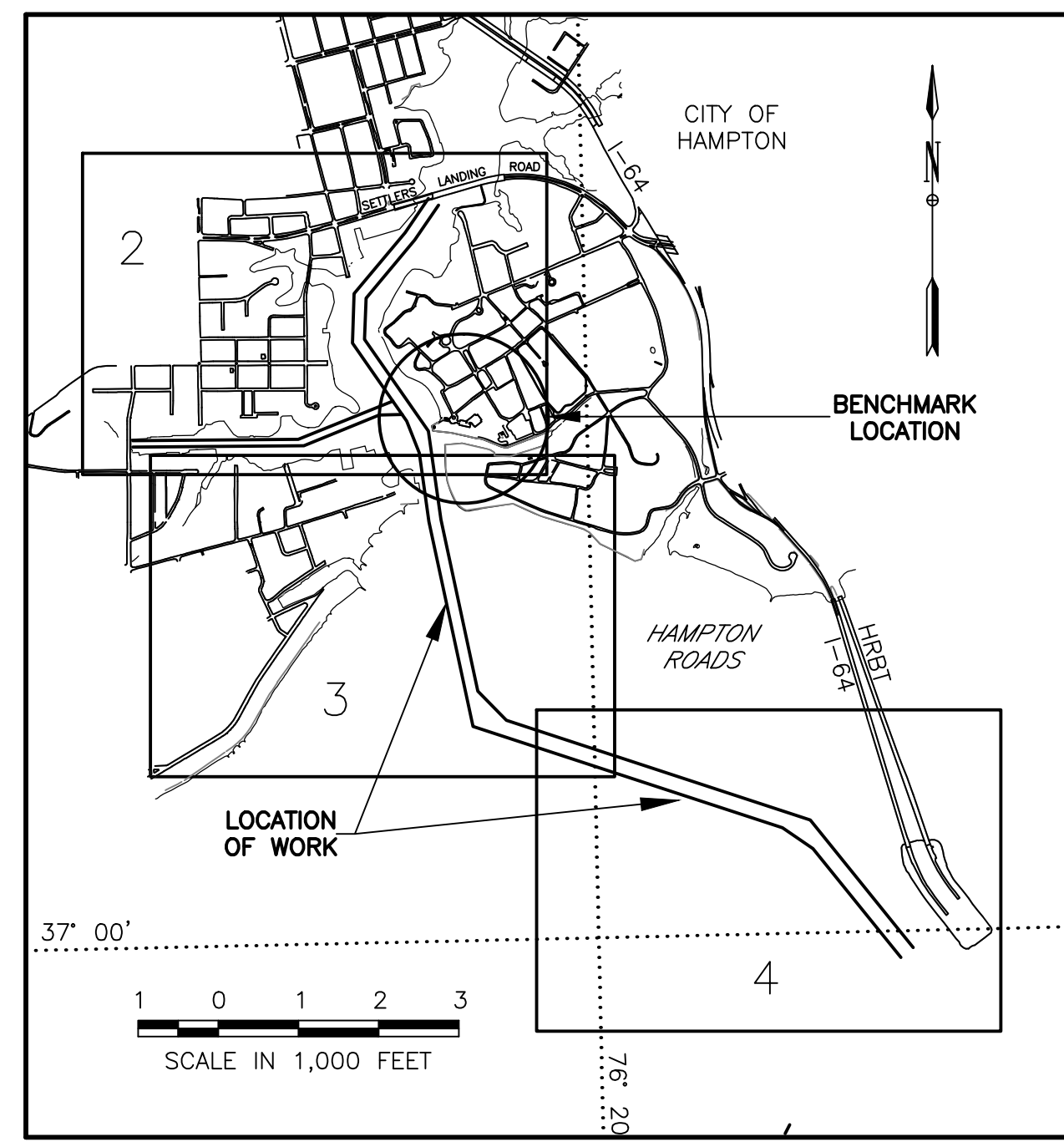

LOCATION MAP

- LEGEND -

---	Approximate location of Virginia Power Co. Submarine Cable
---	Limits Of Channel

COORDINATES OF CENTERLINE STATIONS		
HAMPTON CREEK		
STATION	EAST (X)	NORTH (Y)
0+00.0	12,113,519.11	3,539,993.55
5+18.2	12,113,227.73	3,539,565.05
14+89.3	12,112,604.75	3,538,820.13
20+53.2	12,112,585.18	3,538,256.53
34+51.5	12,113,383.87	3,537,108.73
45+51.3	12,113,538.26	3,536,019.84
70+86.1	12,114,071.47	3,533,541.81
113+86.5	12,118,158.00	3,532,202.45
134+00.1	12,119,424.31	3,530,636.85

COORDINATES OF CENTERLINE STATIONS		
HERBERTS CREEK		
STATION	EAST (X)	NORTH (Y)
0+00.0	12,113,113.19	3,537,497.68
13+43.7	12,111,867.49	3,536,994.07
34+40.1	12,109,771.13	3,536,978.24

INDEX TO DRAWINGS

SHEET NO.	TITLE	FILE NUMBER
1	TITLE SHEET	FILE NO. HTC.2011-06-29.CS(1)
2	MAPPING SHEET	FILE NO. HTC.2011-06-29.CS(2)
3	MAPPING SHEET	FILE NO. HTC.2011-06-29.CS(3)
4	MAPPING SHEET	FILE NO. HTC.2011-06-29.CS(4)

BENCHMARKS	
BENCHMARK	ELEVATION
CE "PIRATES, 1993"	+5.47
CITY OF HAMPTON, "556-1, 1993"	+5.54
USC&GS "F 312, 1952"	+9.07

Elevations are relative to NOS MLLW 1983-2001 NTDE

DEPARTMENT OF THE ARMY
 NORFOLK DISTRICT, CORPS OF ENGINEERS
 NORFOLK, VIRGINIA

REVIEWED: _____	APPROVED: _____
CHIEF, NAVIGATION SUPPORT AND SURVEY SECTION	CHIEF, OPERATIONS BRANCH
SUBMITTED: _____	APPROVED: _____
CHIEF, DESIGN SECTION	CHIEF, WATER RESOURCES DIVISION

The information depicted on this map represents the results of surveys made on the date(s) indicated and can only be considered as indicating the general conditions existing at that time.

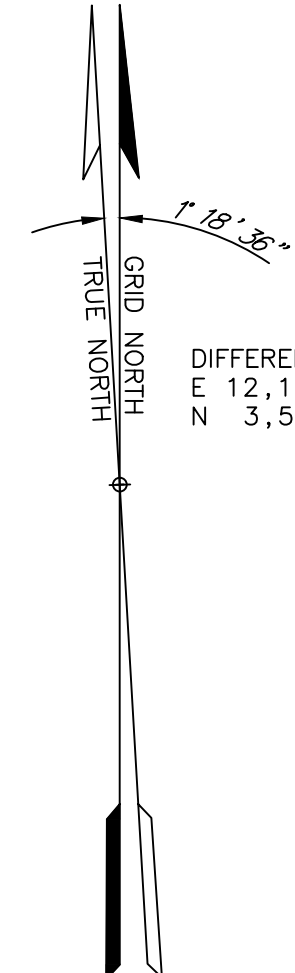

DIFFERENCE OCCURS AT:
E 12,113,000
N 3,539,000

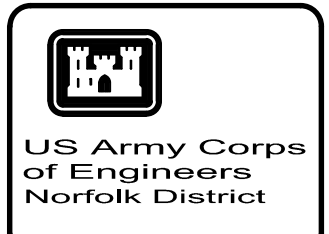
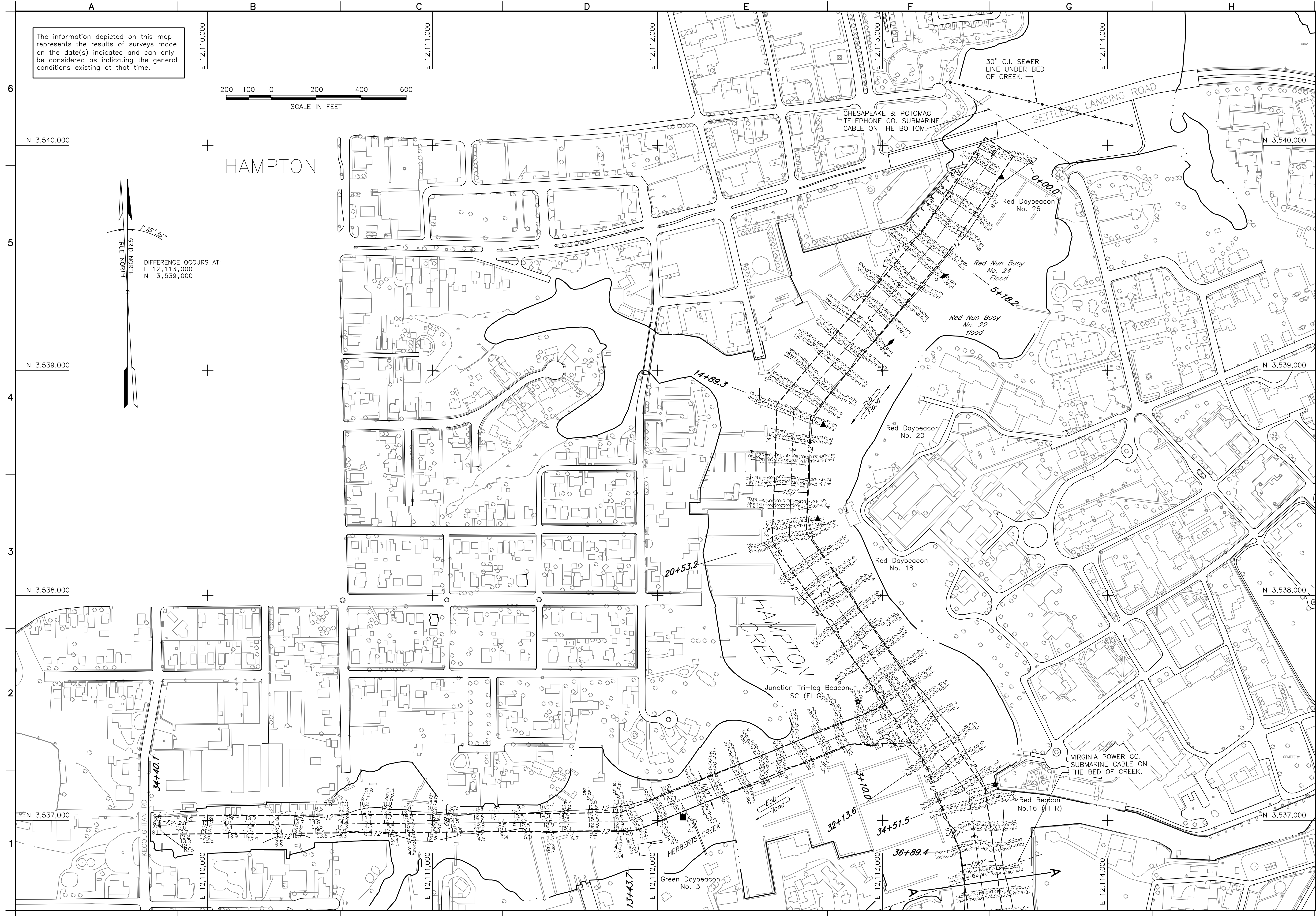

REV.	DATE	DESCRIPTION	BY	APP.

DESIGNED BY: R.J.W.	DATE: 11 OCT 2011
DRAWN BY: M.L.M.	PROJECT: AS SHOWN
CHECKED BY: K.H.	DRAWING NO.: HTG.2011-06-29.CS(2)
APPROVED BY: A.M.P.	SUBMITTED BY: A.M.P.

**HAMPTON CREEK/HERBERTS CREEK
PROJECT CONDITION
SURVEY OF JUNE AND JULY 2011
HAMPTON, VIRGINIA**

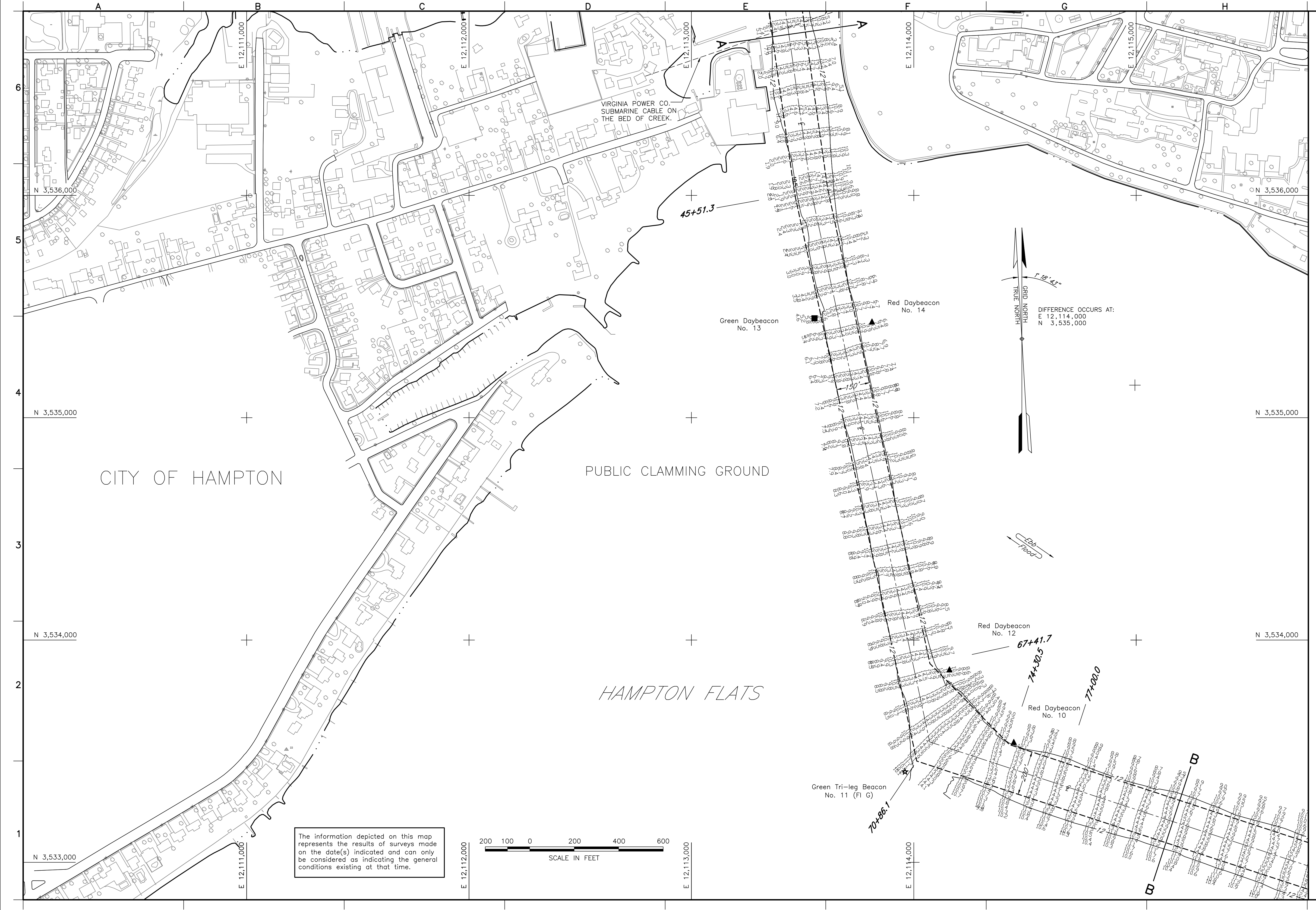

The information depicted on this map represents the results of surveys made on the date(s) indicated and can only be considered as indicating the general conditions existing at that time.

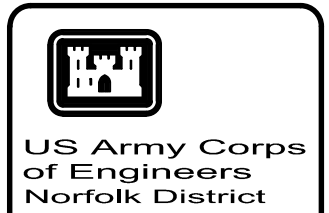

REV.	DATE	DESCRIPTION	BY	APP.

DESIGNED: R.J.W. DRAWN: M.L.M. CHECKED: K.H. SURVEYED BY: A.M.P.	DATE: 11 OCT 2011 AS SHOWN
NORFOLK DISTRICT CORPS OF ENGINEERS NORFOLK, VIRGINIA	DRAWING NO.: HTG 2011-06-29 CS(3) SURVEYED BY: A.M.P.

**HAMPTON CREEK/HERBERT CREEK
PROJECT CONDITION
SURVEY OF JUNE AND JULY 2011
HAMPTON, VIRGINIA**

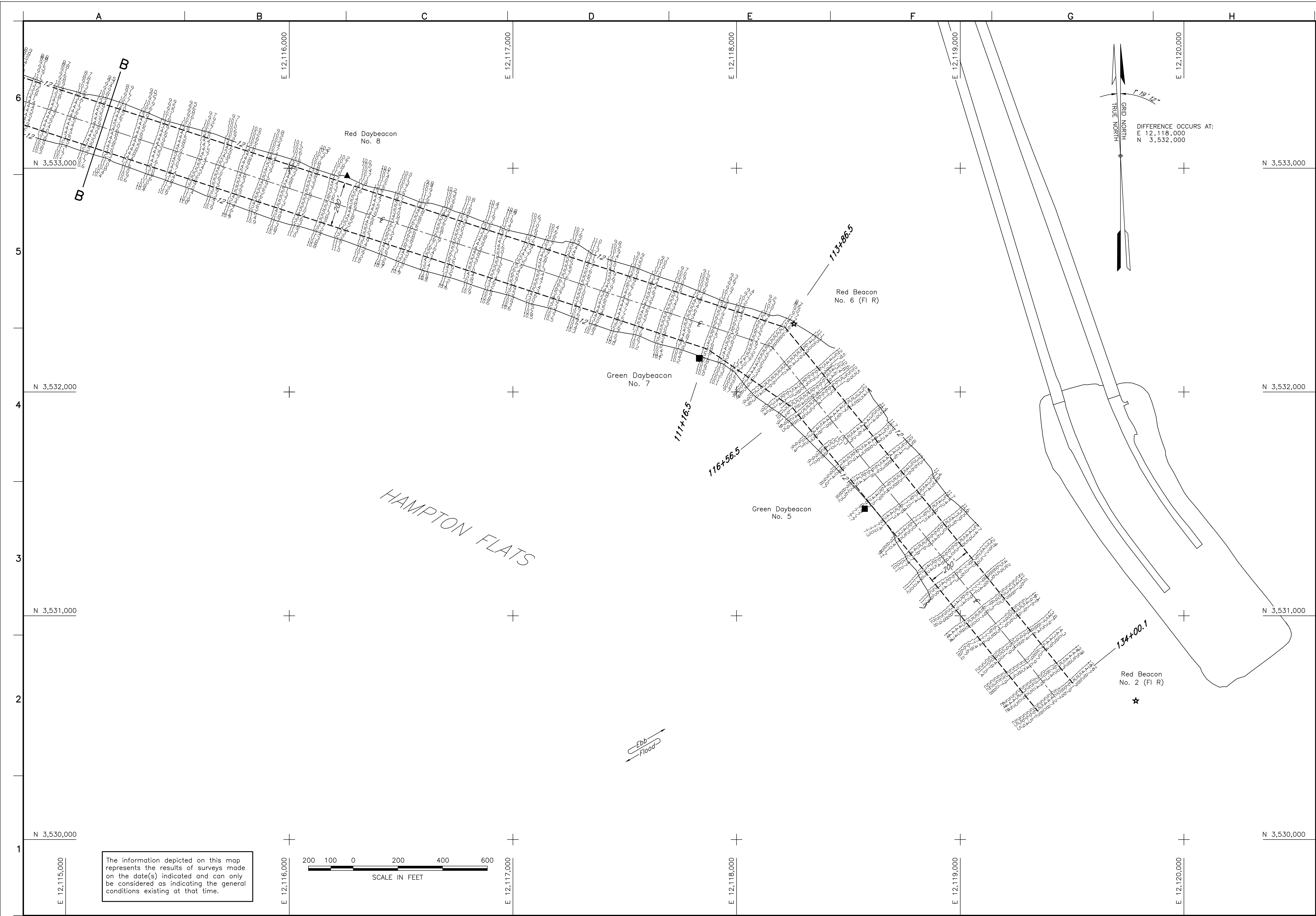

The information depicted on this map represents the results of surveys made on the date(s) indicated and can only be considered as indicating the general conditions existing at that time.

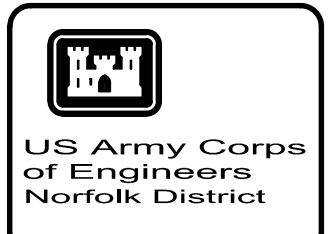
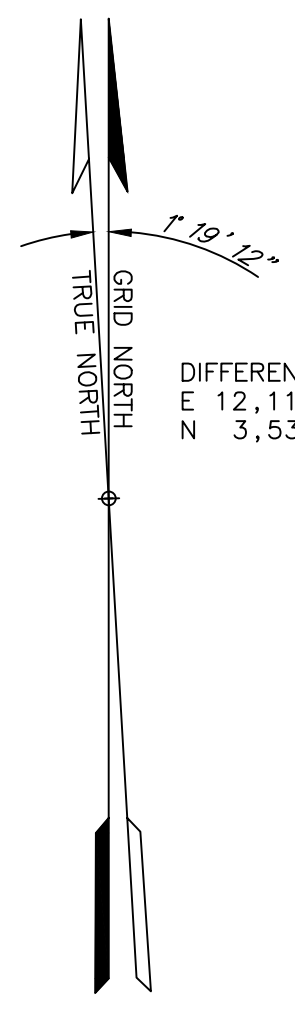
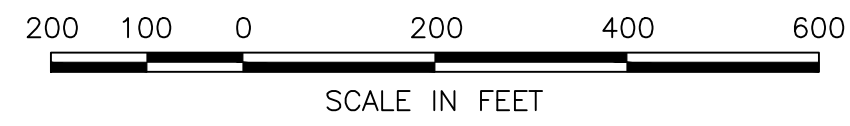

REV.	DATE	DESCRIPTION	BY	APP.

DESIGNED BY: R.J.W.	DATE: 11 OCT 2011
DRAWN BY: M.L.M.	SCALE: AS SHOWN
CHECKED BY: K.H.	
PROJECT NO.: HTG 2011-06-29 CS(4)	
DRAWING NO.:	
SURVEYED BY: A.M.P.	

**HAMPTON CREEK/HERBERT CREEK
PROJECT CONDITION
SURVEY OF JUNE AND JULY 2011
HAMPTON, VIRGINIA**